

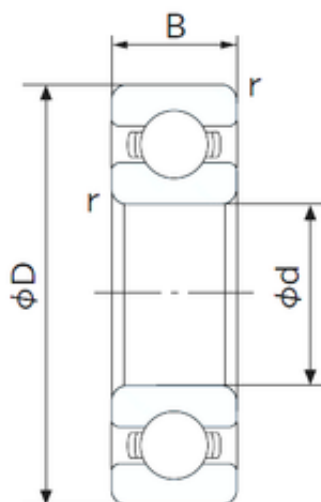

## NTN-SUDAMERICAN,S.A.



16004 16005 16006 16007 16008 16009 16010-  
O&Kai Z1V1 Z2V2 Z3V3 ISO Deep Groove Ball  
Bearing SKF NSK NTN NACHI Koyo FAG OEM

Bearing No. 16004

Size	20x42x8 mm
Bore Diameter	20 mm
Outer Diameter	42 mm
Width	8 mm
d	20 mm
D	42 mm
B	8 mm
C	8 mm
r min.	0.3 mm
da min.	25 mm
Da max.	37 mm
ra max.	0.3 mm
Weight	0.050 Kg
Basic dynamic load rating (C)	7,9 kN
Basic static load rating (C0)	4,5 kN
(Grease) Lubrication Speed	17000 r/min
Category	Single Row Ball Bearings
Inventory	0.0
Manufacturer Name	NACHI
Minimum Buy Quantity	N/A
Weight / Kilogram	0.05
EAN	4991893471410
Product Group	B00308
Enclosure	Open

16004 Bearing 2D drawings and 3D CAD models



## NTN-SUDAMERICAN,S.A.

Precision Class	ABEC 1   ISO P0
Maximum Capacity / Filling Slot	No
Rolling Element	Ball Bearing
Snap Ring	No
Internal Special Features	No
Internal Clearance	C0-Medium
Inch - Metric	Metric
Long Description	20MM Bore; 42MM Outside Diameter; 8MM Outer Race Diameter; Open; Ball Bearing; ABEC 1   ISO P0; No Filling Slot; No Snap Ring; No Internal Special Features
Category	Single Row Ball Bearing
UNSPSC	31171504
Harmonized Tariff Code	8482.10.50.68
Noun	Bearing
Keyword String	Ball
Manufacturer URL	<a href="http://www.nachi.com">http://www.nachi.com</a>
Manufacturer Item Number	16004 BNLS
Weight / LBS	0.11
Outside Diameter	1.654 Inch   42 Millimeter
Outer Race Width	0.315 Inch   8 Millimeter
Bore	0.787 Inch   20 Millimeter
Bore Type	Cylindrical Bore
Configuration	Single Row
Bore Size	20 mm
Width	8 mm
Fillet Radius/Chamfer	0.3 mm
Dynamic Load Rating	7,900 N
Static Load Rating	4,500 N
Limiting Speed - Grease	18,000 rpm



## NTN-SUDAMERICAN, S.A.

Limiting Speed - Oil	21,000 rpm
Factor $f_0$	14.5
Radial Clearance	0.005 to 0.020 mm
$d_a$ (min)	25 mm
$D_a$ (max)	37 mm
$r_a$ (max)	0.3 mm